

RIVERSIDE MALL, ROSEBANK

TO LET

Compiled by: (FOR VIEWING, CONTACT)

Norman Alexander

COMMERCIAL / INDUSTRIAL PROPERTY BROKER
PO BOX 269 CAPE TOWN 8000

TEL. +27 21 465 5907 OFFICE

CELL. +27 83 631 4410

Email: alexnda@telkomsa.net

Tuesday, 18 January 2011



| asking rentals between R90 – R95/sqm

Riverside Centre	Cnr Main and Belmont road	Rondebosch	Retail	Shop 02	Lower Ground Floor	Immediately	132.24
Riverside Centre	Cnr Main and Belmont road	Rondebosch	Retail	Shop 10	Lower Ground Floor	Immediately	89
Riverside Centre	Cnr Main and Belmont road	Rondebosch	Retail	Shop 11 & 12	Lower Ground Floor	Immediately	55
Riverside Centre	Cnr Main and Belmont road	Rondebosch	Retail	Shop 17	Lower Ground Floor	Immediately	114.8
Riverside Centre	Cnr Main and Belmont road	Rondebosch	Retail	Shop 32	Upper Ground Floor	Immediately	71.94
Riverside Centre	Cnr Main and Belmont road	Rondebosch	Retail	Shop 39	Upper Ground Floor	Immediately	105.32

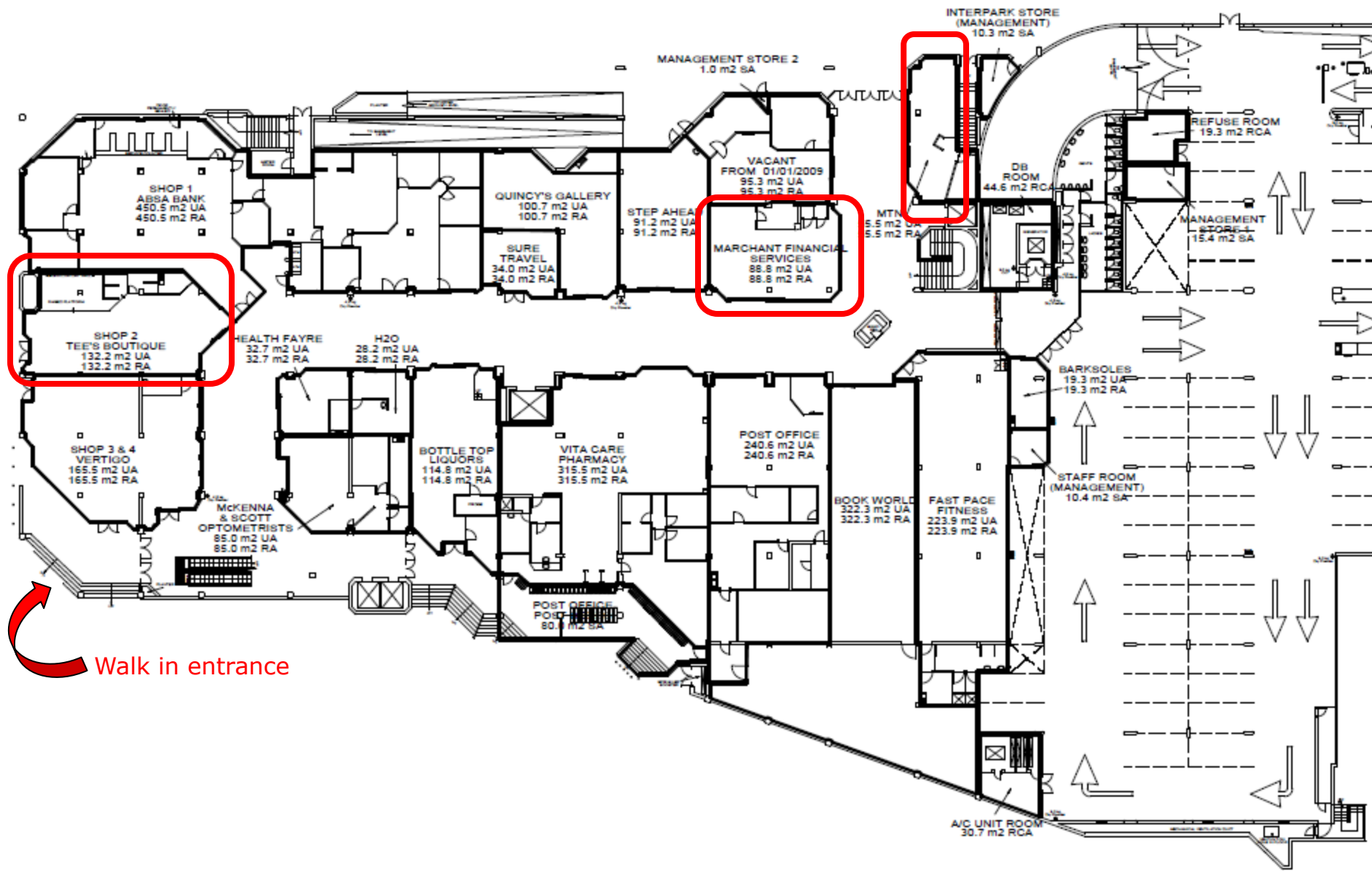

Walk in entrance



Shop 39

17/01/2011 09:48

Health Fay

Shop 2

ABSA

TO LET

JAMES WILSON
01753 811111

PROPERTY

TO LET

MENS CLINIC
INTERNATIONAL
FOR GENTLE MEDICAL
PROCESSES

Tel: 0860 362 867

or
5535 CL7 to 32340
and we will call you

www.menshealth.co.za

17/01/2011 09:51



Shop 11 & 12

17/01/2011 09:56



View from parking garage 17/01/2011 09:56
towards entrance

Back to
[Keyword Search](#)>